

CECO

Burgess-Aarding

MODEL BEO - Engine Exhaust Silencer

Burgess-Aarding, Pioneer of Industrial Silencing Reintroduces
The Original Reactive Type Engine Exhaust Silencer

Description:

Burgess-Aarding chambered reactive type engine silencers are specifically designed to provide ideal noise reduction of reciprocating engine exhaust gas and are available in six different grades. Burgess-Aarding offers the critical plus grade model BMA (30-35 dB) hospital grade model BEO (35-40 dB), and hospital plus grade model BEOA (40+ dB).

Features:

- Noise reduction up to 40 dB
- Economically priced
- Long service life
- All welded steel construction for explosion resistant service

Theory of Operation:

The Burgess-Aarding patented principle used in the design of Burgess-Aarding silencers involves passing gas flow through snubbing chambers. These snubbing chambers house an arrangement of ported tubes, which attenuate the noise to smooth, quiet flow.

Specifications:

Maximum Noise Attenuation: 40 dB

Typical Sizes: 1" - 48"

Standard End Connections: NPT or 125# ANSI Flanged

Standard Material of Construction: Carbon Steel

Finish: Prime Coated Exterior

Typical Burgess-Aarding reactive type silencer

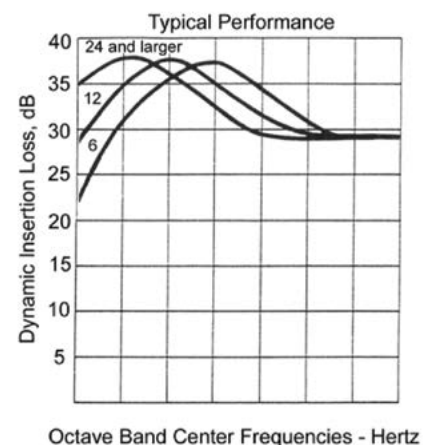

MODEL BEO - Engine Exhaust Silencer

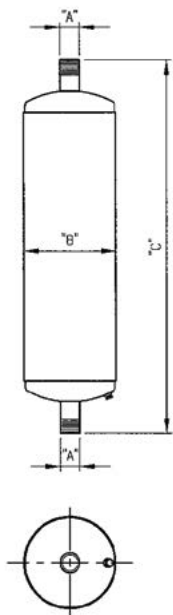

BEO
Sizes 2 1/2" Thru 4"

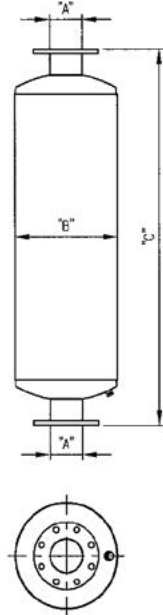

BEO
Sizes 5" Thru 48"

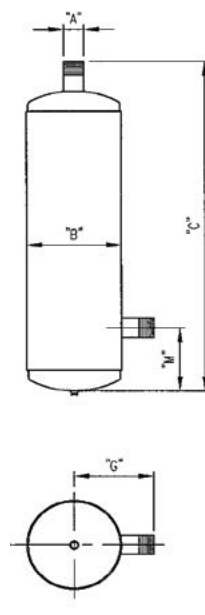

BEO-L
Sizes 2 1/2" Thru 4"

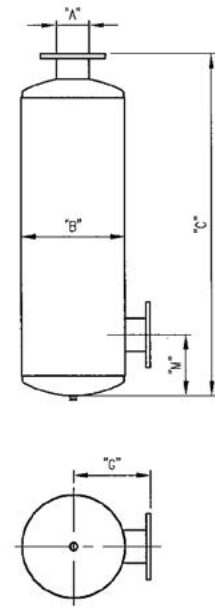

BEO-L, BEO-M & BEO-H
Sizes 5" Thru 48"

Catalog Number	Dimensions in inches											Estimated Weight in lbs.	
	All Models		BEO	BEO-L, BEO-M BEO-H		M						BEO BEO-L	BEO-M BEO-H
	A	B	C	C	G	BEO-L		BEO-M		BEO-H			
						Min.	Max.	Min.	Max.	Min.	Max.		
BEO-2.5	2 1/2	10	42	40	8	4 1/2	10	—	—	—	—	45	—
BEO-3	3	12	48	44	10	5 1/2	10	—	—	—	—	70	—
BEO-3.5	3 1/2	14	54	51	11	6	12	20	28	34	40	95	102
BEO-4	4	14	66	63	11	6	16	23	38	42	52	120	135
BEO-5	5	16	78	75	11	7	22	28	47	49	64	190	215
BEO-6	6	18	97	94	12	8	29	36	60	61	82	270	310
BEO-8	8	24	110	108	15	10	34	46	68	70	94	455	490
BEO-10	10	30	136	133	18	12	40	54	82	90	119	830	990
BEO-12	12	36	143	141	21	14	46	36	88	93	124	1,135	1,300
BEO-14	14	36	199	196	22	15	69	76	129	127	178	1,545	1,860
BEO-16	16	42	213	209	25	17	68	84	134	137	189	2,205	2,725
BEO-18	18	48	214	211	28	19	68	85	135	139	189	3,200	3,325
BEO-20	20	54	228	225	31	21	68	93	142	153	201	3,700	3,750
BEO-22	22	60	232	228	35	23	74	89	141	149	201	5,050	5,150

NOTES: - Flanges are drilled to match 125 lb. American Standard Flanges
 - Larger units available upon request
 - Specifications subject to change without notice

Nunspeet, The Netherlands - Aarding
 Industrieweg 59 • P.O. Box 65 • 8070 AB Nunspeet
 Phone: +31-341-252-635 • Fax: +31-341-262-112
www.cecoenviro.com/burgess-aarding

Elma, NY, USA - Aarding
 2711 Transit Road • Suite 125-128 • Elma, NY 14059
 Phone: 716-662-6540
www.cecoenviro.com/burgess-aarding